

# IEC 60320 C13 to IEC 60320 C8 Plug

Note:

1. Rating: 10A 125V
2. Insulation Resistance: 100MΩ
3. Dielectric Voltage: 2000V/sec

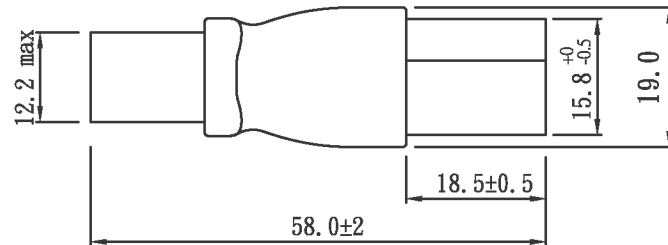
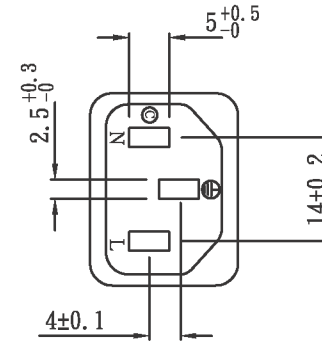
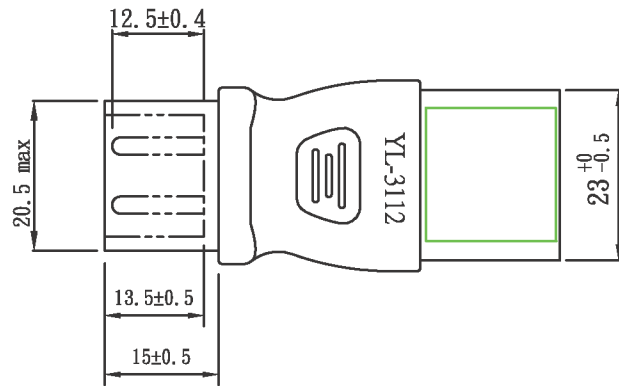
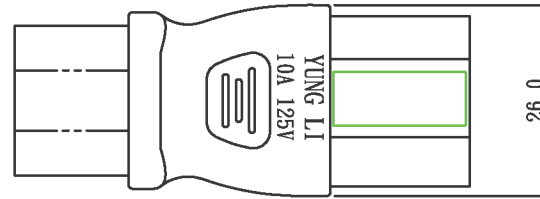
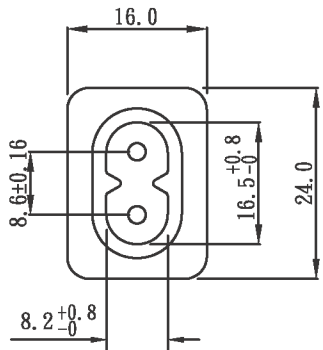

TOLERANCE >0±0.30 >1.0±0.50 >10.0±1.0 >20.0±2.0 Angle: ±1°	APPROVED		DATE		<b>PowerFig</b> www.powerfig.com			
	CHECKED		DATE					
	DRAWN		DATE					
	TYPE	YL-3112			P/N			
	DRAWING NO.	CY-A3112			SCALE	1:1	UNIT	mm